

TERMINALES COBRE ESTAÑADO

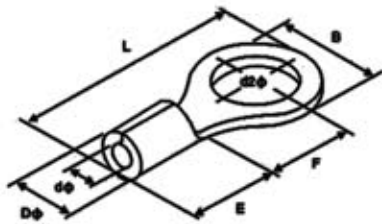

CLAVE	A.W.G	d2 φ (mm)	Dimensiones (mm)					
			B	L	F	E	Dφ	dφ
T2-1/4	2	6.4	15.3	39.0	17.4	14.0	13.3	9.4
T2-5/16		8.4	15.3	39.0	17.4			
T2-3/8		10.5	15.3	39.0	17.4			
T2-1/2		13.0	22.0	42.7	17.7			
T4-3/16	4	4.3	12.2	33.2	15.1	12.0	11.5	7.7
T4-1/4		6.4	12.2	33.2	15.1			
T4-5/16		8.4	16.5	33.7	13.5			
T4-3/8		10.5	16.5	33.7	13.5			
T4-1/2		13.0	22.0	42.5	19.5			
T6-3/16	6	4.3	12.0	29.8	13.3	10.5	9.5	5.8
T6-1/4		6.4	12.0	29.8	13.3			
T6-5/16		8.4	16.0	31.8	13.3			
T6-3/8		10.5	16.0	31.8	13.3			
T6-1/2		13.0	22.0	41.0	19.5			
T8-3/16	8	4.3	8.8	23.8	9.3	8.5	7.2	4.5
T8-1/4		6.4	12.0	23.8	9.3			
T8-5/16		8.4	15.0	29.8	13.8			
T8-3/8		10.5	15.0	29.8	13.8			
T8-1/2		13.0	20.0	33.5	15.0			
T1/0-1/4	1/0	6.4	22.0	49.7	20.7	14.0	13.3	9.4
T1/0-5/16		8.4						
T1/0-3/8		10.5						
T1/0-1/2		13.0						
T2/0-5/16	2/0	8.4	24.0	51.0	20.0	19.0	17.5	13.3
T2/0-3/8		10.5						
T2/0-1/2		13.0						
T3/0-5/16	3/0	8.4	27.0	54.2	20.7	20.0	19.5	14.5
T3/0-3/8		10.5						
T3/0-1/2		13.0						
T4/0-3/8	4/0	10.5	28.5	55.6	20.4	21.0	22.1	16.4
T4/0-1/2		13.0						

CONECTOR A TOPE COBRE ESTAÑADO

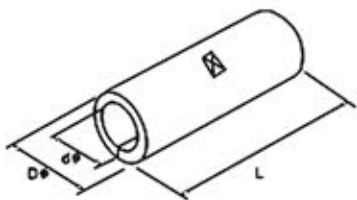

CLAVE	Sección de Conductor		Dimensiones (mm)		
	A.W.G	mm ²	Dφ	dφ	L
TC8	8	10	7.1	4.5	21.0
TC6	6	16	9.0	5.8	26.0
TC4	4	25	11.4	7.7	29.0
TC2	2	35	13.3	9.4	32.0
TC1/0	1/0	50	15.4	11.4	36.0
TC2/0	2/0	70	17.5	13.3	37.0
TC3/0	3/0	95	19.4	14.5	38.0
TC4/0	4/0	120	22.0	16.4	38.0